

# Sample suspension instructions for

Rovers Evalyn® Brush



The following sample suspension instructions for self-collected sample using Rovers Evalyn® Brush are from the **cobas®** HPV Test IFU (P/N 05641268001) and **cobas®** HPV IFU (P/N 09199578001).

**Self-collected sample must be placed into medium after sample has been collected.**

- **Read all instructions before starting sample suspension.**
- For sample collection, follow the collection device manufacturer's Instructions for use.
- Once the sample has been collected, continue with the following instructions to preserve the sample:

## Handle the collected sample with care

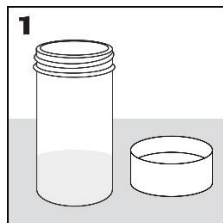

**1. Carefully** uncap the vial containing medium and place it on a stable, flat surface.

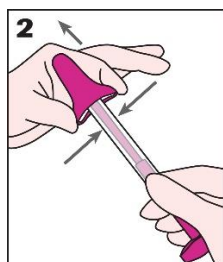

**2. Remove** the pink cap from the Evalyn brush **taking care not to touch the exposed end.**

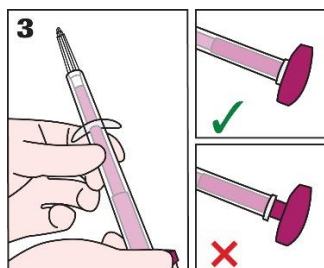

**3. Press** the pink plunger down until it clicks into place to expose the white brush. **Take care to keep the exposed brush from touching anything** (e.g., fingers, surfaces).

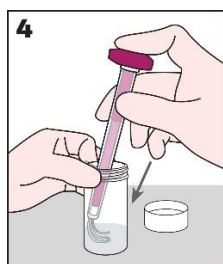

**4. Hold** the vial with one hand then with the other hand place the white brush into the vial so that the **bristles are fully immersed in the medium and the wings are past the opening of the vial.**

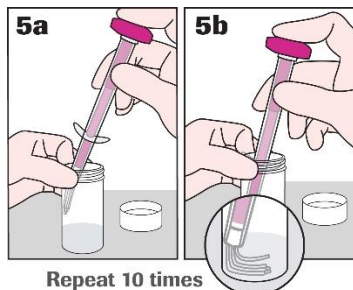

**5. Holding onto** the vial, vigorously plunge the brush, **smashing** the white brush **against the bottom and interior wall** of the vial **10 times to maximize sample release.** Be careful not to splash.



**6. Remove** the white brush by carefully drawing the brush up along the inner wall of the primary vial until the brush is no longer submerged in the medium. **Hold the brush against the inner vial wall to drain fluid** off the brush. Place the Evalyn brush back inside the packaging and discard.

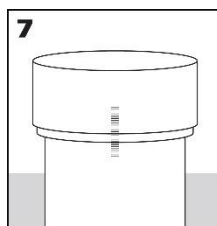

**7. Re-cap** the vial and tighten until **the lines on the cap and vial meet or slightly overlap** to prevent leakage. Store upright.

**8. The sample can now be processed** with the **cobas®** HPV Test or **cobas®** HPV.

## Glossary

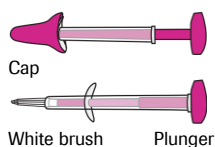

**Evalyn Brush:** The self collection device used to collect sample.

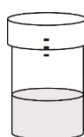

**Vial:** A container which contains 20 mL of clear solution. The specimen you collect will need to be transferred into this container and this container will be sent to the lab for processing.

**Medium:** What the liquid that comes in the vial is called.

**Trademarks and Patents**

See <https://diagnostics.roche.com/us/en/about-us/patents>

**Copyright**

©2024 Roche Molecular Systems, Inc.

**Manufacturer and distributor**



Roche Molecular Systems, Inc.  
1080 US Highway 202 South  
Branchburg, NJ 08876, USA  
[www.roche.com](http://www.roche.com)

Made in USA

Distributed by Roche Diagnostics  
9115 Hague Road  
Indianapolis, IN 46250-0457, USA  
(For Technical Assistance call the  
Roche Response Center  
toll-free: 1-800-526-1247)

**Document revision**

Document Revision Information	
Doc Rev. 1.0 09/2024	First Publishing.